

COGNEX

Install the In-Sight Autofocus Accessory

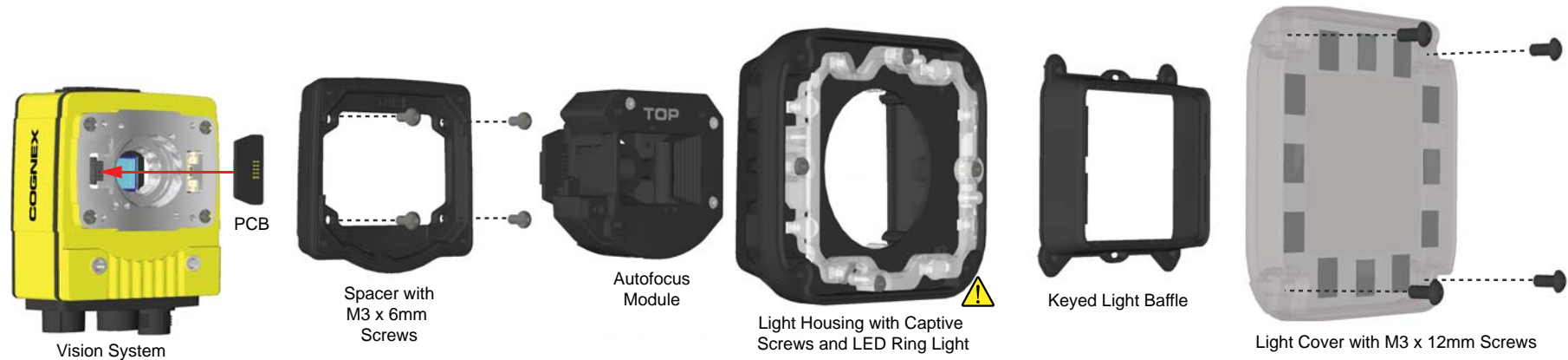

Note: The illumination accessory (ISLM-7000-WHI) is sold separately. It is the only lens cover available for the autofocus module and is required for IP67 rating.

1. Remove the rubber faceplate covering the vision system's image sensor window.
2. Remove the protective film covering the vision system's threaded lens opening.
3. Plug the PCB into the lighting connector on the vision system faceplate.
4. Place the spacer on top of the vision system with "TOP" oriented upward. Verify seating of the gasket on the bottom of the spacer. Insert the four M3 x 6mm screws and use a 2mm hex wrench (included) to torque screws to 0.34 Nm (3 in-lb).
5. An 8mm M12 lens is pre-installed in the autofocus module accessory and held in place with a threaded lens ring on the underside of the autofocus module. There are two alignment pins on the base of the autofocus module; seat the pins into the vision system faceplate. There are three captive screws in the autofocus module; partially thread the screws into the vision system faceplate using a 1.5mm hex wrench (included). Once threaded, torque screws to 0.5 Nm (4.43 in-lb).
6. Place the light housing with LED ring light on top of the spacer, with "TOP" oriented upward. Verify seating of the gasket on the top of the spacer. There are four captive screw access holes. Use a 2mm hex wrench (included) to torque captive screws to 0.34 Nm (3 in-lb).

CAUTION:

- Do not hot-plug the LED ring light; verify the vision system is not receiving power when connecting or disconnecting the LED ring light.
 - A connector protrudes from the underside of the light housing. To prevent damage, it is recommended the light housing not be removed from the box until ready to be assembled.
7. If using a filter, insert the filter in the light baffle so that it is held in place between the light baffle's filter retention tabs. Ensure the filter retention tabs are flush with the top surface of the filter. For more information, refer to the *In-Sight® 7600/7800 Series Vision System Reference Manual*.
 8. The light baffle is keyed to fit the LED ring light structure and snaps into place with the keyed tabs sitting flush over each light housing captive screw access hole. With the "TOP" of the light housing oriented upward, tilt the light baffle toward the light housing and maneuver the light baffle past the top of the LED ring light structure. Compress the light baffle and maneuver the bottom of the baffle past the bottom of the LED ring light structure until the light baffle snaps into place.
 9. Attach the front cover. Insert the four M3 x 12mm screws and tighten use a 2mm hex wrench (included) to torque screws to 0.31 Nm (2.75 in-lb).

CAUTION:

- To reduce emissions, a ferrite must be attached to the vision system's Breakout cable or I/O Module cable. For more information, refer to the *In-Sight® 7600/7800 Series Vision System Reference Manual*.
- Tighten all illumination of the accessory screws in the following sequence.



P/N 590-10028 Rev. A

Copyright © 2017 Cognex Corporation. All Rights Reserved.
Printed in the U.S.A.